

S3P S3.5P

50Hz

**Deep-Well
Submersible
Pump 3"-3.5"**

hydroo[®]



PRODUCTS

Presentation	03
Technical Data	
3" S3P	04
3.5" S3.5P	07
4" S4P	10
Installation dimensions	
3" S3P	18
3" S3.5P	19
4" S4P	20
4" HYA4	23
4" HY04	25

PRESENTATION

Hydroo Pump Industries SL is an enterprise specialised in the research, development and large-scale production of Stainless Steel centrifugal pumps. We have a vertical integration of the production processes, standing out stamping, welding and motor wiring in 6 value centers and production units. All of them with a high performance management on pump engineering and production quality.

HYDROO has set up a wide range of pumping solutions for many applications as building services, industry, irrigation and industrial process. Customers enjoy of the highest performance in booster sets and pressurization, fire-fighting sets, pumping of underground water, HVAC and drainage and sewage, utilities, desalination and OEM integrations. Versions in 50 Hz and 60 Hz are available, as well as any modification on materials, on request.

Global water challenges require excellence in pumping technologies and close cooperation between pump designers, manufacturers and pump engineers. In order to better meet the customers' needs and requirements our company is facing an expansion of its operations worldwide, providing timely and effective services in more than 70 countries. With tight relationships in many regions, we're proud to introduce a new regional value center for Europe. We are based near Barcelona at the Girona industrial area. Hydroo is a trademark to forge excellent and successful business relationships with European customers by means of an operative assembling unit and an application engineering unit. HYDROO trademark wants to symbolize the firm commitment for a high level service to European customers.

At Hydroo we bet on a high level service to European pump partners.

S3P 50Hz 3" Submersible Multistage

Technical Data

Applications

For water supply from wells or reservoirs.
For domestic use, for civil and industrial applications.
For garden use and irrigation.

Operating conditions

Maximum fluid temperature up to +35°C.
Maximum sand content: 0.25%.
Maximum immersion: 80m.
Minimum well diameter: 3".

Motor and pump

- Rewindable motor
- Three-phase: 350V-400V/50Hz
- Single-phase: 180V-230V/50Hz
- Equipped with start-up control box or digital auto-control box
- Pumps are designed by casing stressed
- NEMA dimension standards
- Performance curve tolerance according to ISO 99906 annex A

Outlet diameter

1"

S3P2 - 10

S3P: Stainless steel submersible 3" borehole pump, sand resistant type, POM impeller

2: Rated flow (m³/h)

10: Number of impellers

hydroo®

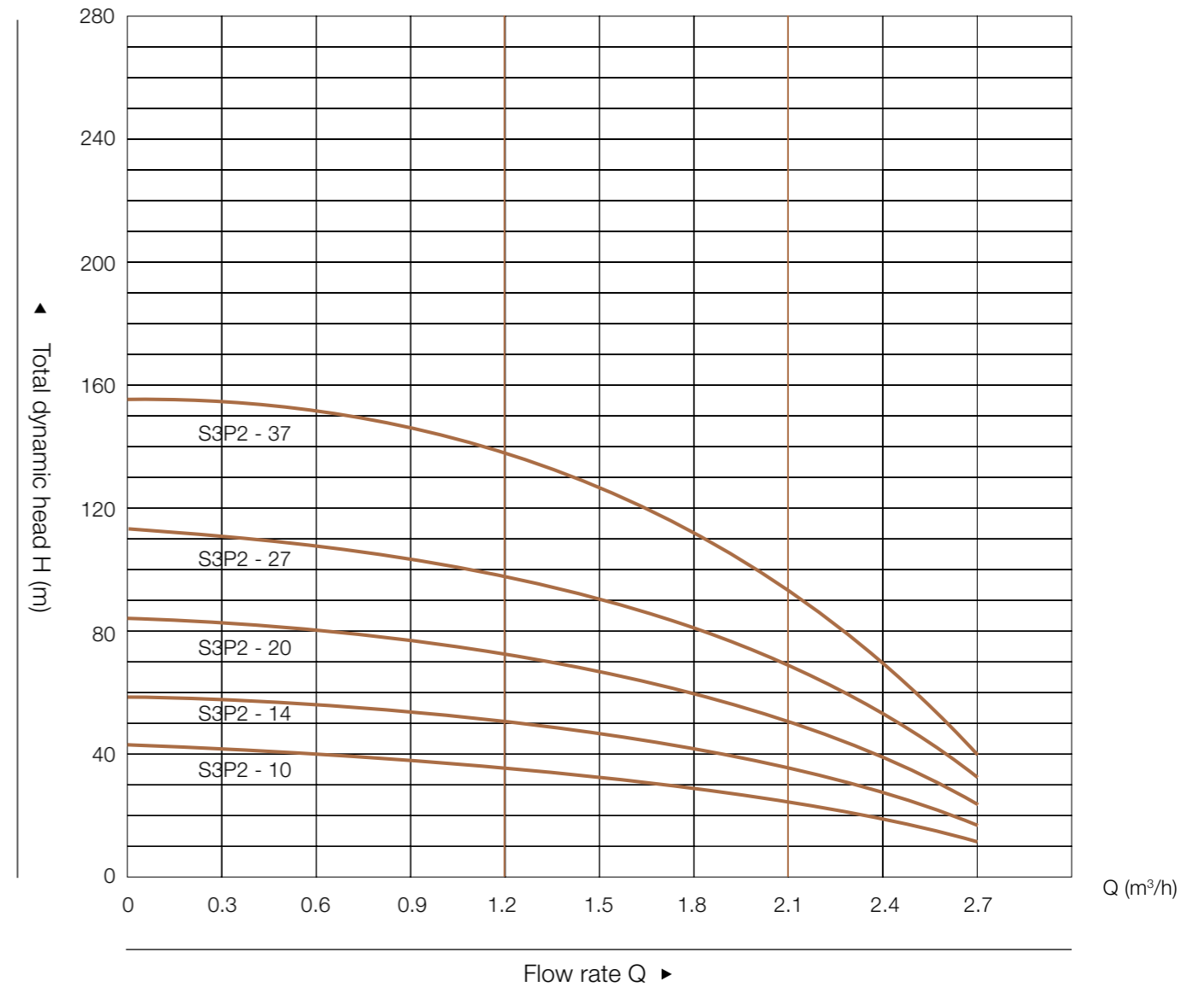

Performance table

Type	Motor power		Delivery N~2850r/min										
	KW	H	Q(m³/h)	0	0.3	0.6	0.9	1.2	1.5	1.8	2.1	2.4	2.7
S3P2-10	0.25	0.33	H(m)	42	41	39	38	36	33	29	24	18	10
S3P2-14	0.37	0.5		59	57	55	53	50	46	40	34	25	14
S3P2-20	0.55	0.75		84	82	78	76	72	66	58	48	36	20
S3P2-27	0.75	1		113	111	105	102	97	89	79	65	48	27
S3P2-37	1.1	1.5		155	152	144	140	133	122	107	89	66	37

Components	Material
Delivery casing	AISI 304 SS
Strainer	AISI 304 SS
Diffuser	Polycarbonate
Impeller	POM
Shaft	AISI 304 SS
Shaft coupling	AISI 304 SS
Wear ring	Rubber NBR
Motor external casing	AISI 304 SS
Mechanical seal	Special seal for deep well (carbor-sic/tc)
Shaft	AISI 304 SS
Bearing	NSK
Seal lubricant oil	Oil for food machinery and pharmaceutical use.

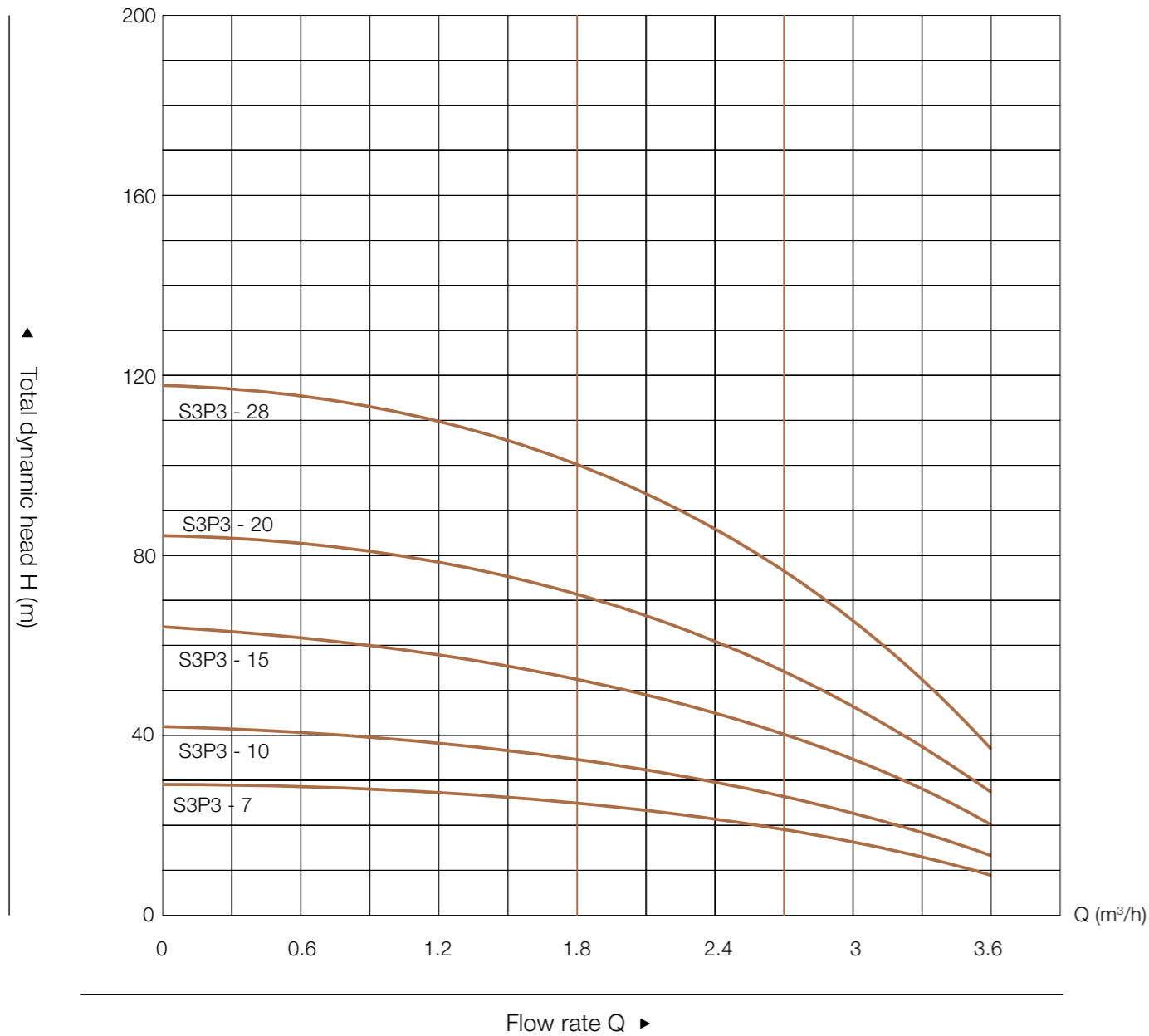

Performance table

Type	Motor power		Delivery N≈2850r/min													
	KW	H	Q(m³/h)	0	0.3	0.6	0.9	1.2	1.5	1.8	2.1	2.4	2.7	3	3.3	3.6
S3P3-7	0.25	0.33	H(m)	29	29	29	28	27	26	25	23	21	19	16	13	9
S3P3-10	0.37	0.5		42	41	41	40	39	37	36	33	31	27	23	18	13
S3P3-15	0.55	0.75		63	62	61	60	58	56	53	50	46	41	35	27	20
S3P3-20	0.75	1		84	83	82	80	78	74	71	67	61	54	46	37	27
S3P3-28	1.1	1.5		117	116	114	112	109	104	100	93	86	76	65	51	37

S3.5P 50Hz 3.5" Submersible Multistage

Tecnical Data

Applications

For water supply from wells or reservoirs.
For domestic use, for civil and industrial applications.
For garden use and irrigation.

Operating conditions

Maximum fluid temperature up to +35°C
Maximum sand content: 3%
Maximum immersion: 120m.
Minimum well diameter: 3.5"

Motor and pump

- Rewindable motor
- Three-phase: 350V-415V/50Hz
- Single-phase: 150V-240V/50Hz
- Equipped with start-up control box

Outlet diameter

1 1/4"

S3.5P2 - 9

S3.5P: Stainless Steel submersible 3,5" borehole pump, sand-resistant type, POM impeller
2: Rated flow (m3/h)
9: Number of impeller

hydroo®



Components	Material
Pump casing	AISI 304 SS / 201 SS
Outlets	Cast-Cu
Inlets	Cast-Cu
Strainer	AISI 304 SS
Diffuser	Polycarbonate
Impeller	POM
Pump shaft	AISI 304 SS / 201 SS
Shaft coupling	AISI 304 SS / 201 SS
Motor casing	AISI 304 SS / 201 SS
Top chock	Cast-Cu / Cast-Iron
Mechanical seal	Graphite-Ceramic / TC
Motor shaft	AISI 304 SS
Bearing	NSK / C&U
Seal lubricant oil	10# White oil

S3P 50Hz 3"

Installation
dimension

hydroo®

S3.5P 50Hz 3,5"

Installation
dimension

hydroo®

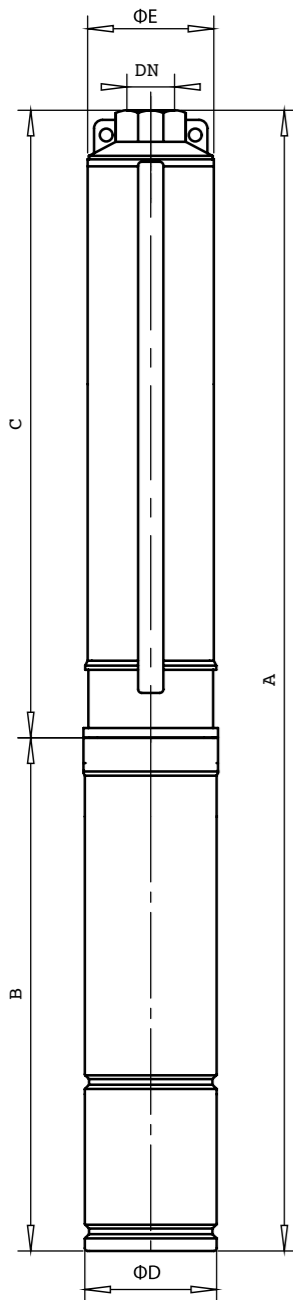

Model	Size (mm)						Weight (kg)	
	A	B	C	DN	ΦE	ΦD	Pump with motor	Controller
S3P2-10	777	338	439	1"	69	72	7.3	0.75
S3P2-14	891	363	528	1"	69	72	8.3	0.75
S3P2-20	1093	407	686	1"	69	72	10.3	0.75
S3P2-27	1324	458	866	1"	69	72	12.5	0.75
S3P2-37	1636	523	1113	1"	69	72	15.2	0.75

Model	Size (mm)						Weight (kg)	
	A	B	C	DN	ΦE	ΦD	Pump with motor	Controller
S3P3-7	736	338	398	1"	69	72	7.1	0.75
S3P3-10	839	363	476	1"	69	72	8.1	0.75
S3P3-15	1037	407	630	1"	69	72	10.1	0.75
S3P3-20	1219	458	761	1"	69	72	12.1	0.75
S3P3-28	1516	523	993	1"	69	72	14.7	0.75

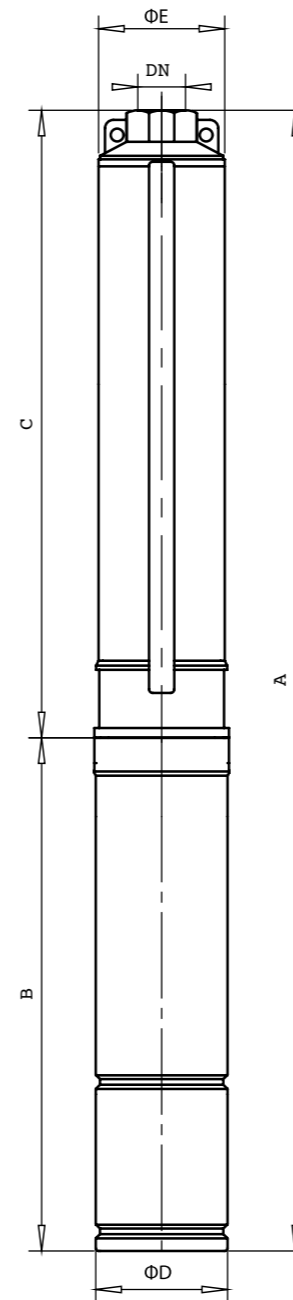

Model	Size (mm)						Weight (kg)	
	A	B	C	DN	ΦE	ΦD	Pump with motor	Controller
S3.5P2-9	841	375	466	1.5"	90	88	13.5	0.75
S3.5P2-13	1011	400	611	1.5"	90	88	16	0.75
S3.5P2-16	1110	415	695	1.5"	90	88	17.62	0.75
S3.5P2-18	1185	435	750	1.5"	90	88	18	0.75
S3.5P2-22	1382	486	896	1.5"	90	88	24	0.75
S3.5P2-28	1600	536	1064	1.5"	90	88	27	0.75

Model	Size (mm)						Weight (kg)	
	A	B	C	DN	ΦE	ΦD	Pump with motor	Controller
S3.5P3-8	854	375	479	1.5"	90	88	14.1	0.75
S3.5P3-11	978	400	578	1.5"	90	88	15	0.75
S3.5P3-13	1093	415	678	1.5"	90	88	16.3	0.75
S3.5P3-15	1179	435	744	1.5"	90	88	17.4	0.75
S3.5P3-16	1212	435	777	1.5"	90	88	18	0.75
S3.5P3-18	1328	486	842	1.5"	90	88	18.2	0.75
S3.5P3-19	1361	486	875	1.5"	90	88	19	0.75
S3.5P3-23	1577	536	1041	1.5"	90	88	23.6	0.75

hydroo®

Be pumping partners

HYDROO Pump Industries SL
Ctra. Girona-Banyoles, km. 10
17843 Palol de Revardit
Catalonia. Spain
Tel. +34 972 394 654
E-mail: info@hydroo.com
www.hydroo.com

201835-CTL-SJP-EN
subject to amendments

